



## *Haven HTS1*

### *Revit Model Features*

1. The HTS1 Revit model enclosed comprise of two separate models to be used in conjunction with each other.
  - a. The ceiling mounted supply grille.  
Filename: **Nuaire\_IfcAirTerminal\_Hts1.rfa**  
This is classed as an 'Air Terminal' within Revit
  - b. The semi-rigid ducting connector for your main ducting run.  
Filename: **Nuaire\_IfcDuctFittingType\_Haven\_Duct\_Connector.rfa**  
This is classed as a duct fitting within Revit.

1x duct connector must be used with each supply grille.

The physical HTS1 kits are supplied with 1m of 75mm semi-rigid radial duct.

The supply grille and the duct connector must be connected by yourself in the Revit project environment using 75mm semi-rigid ducting.

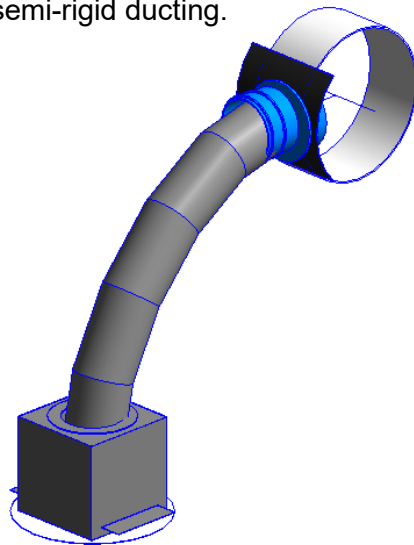

2. The duct connector model will act like a regular tee-piece duct fitting in the Revit project. A small 'phantom' length of ducting is shown on the duct connector model (see the grey 'ring' item below) simply to host the duct connection objects, but this length of duct will not be present in the physical item. The real connectors are tapped directly into your main ducting.  
The size of this main duct must match your main ducting run and can be changed via the '**Main Duct Diameter**' parameter in the model's Properties window under the '**Dimensions**' rollout.

Dimensions	
Main Duct Diameter	200.0

Dimensions	
Main Duct Diameter	400.0

